



- Available Immediately
- Dock High Door
- EC-1 Zoning
- Central Denton Location

1017 SHADY OAKS INDUSTRIAL/FLEX

INDUSTRIAL/FLEX

1017 SHADY OAKS DR, DENTON, TEXAS 76205

3,950^{+/-} SF AVAILABLE



AVAILABLE FOR LEASE

LEASE RATE \$6.50/NNN

SPACE AVAILABLE - 3,950 SF (1,032 SF Office)
BUILDING SIZE - 25,260 SF
SUITE # - 400
OF STORIES - 1
YEAR BUILT - 1986
DOCK HIGH DOORS - 1
LOT SIZE - 1.07 AC
ZONING - EC-1

PROPERTY DESCRIPTION

Finished out flex space with office for lease available immediately.

Located off Dallas Drive & Teasley Lane with easy access to Loop 288 & I-35.

FOR MORE INFORMATION PLEASE CONTACT ALEX PAYNE/BRAD ANDRUS

1517 Centre Place Dr., Ste 250 Denton, TX 76205

Office 940.891.2947 Alex 972.979.7727 Brad 940.368.3588

Copyright©2015 Axis Realty Group

www.axisrealty.biz

alex@axisrealty.biz/brad@axisrealty.biz

FLOOR PLAN

INDUSTRIAL/FLEX

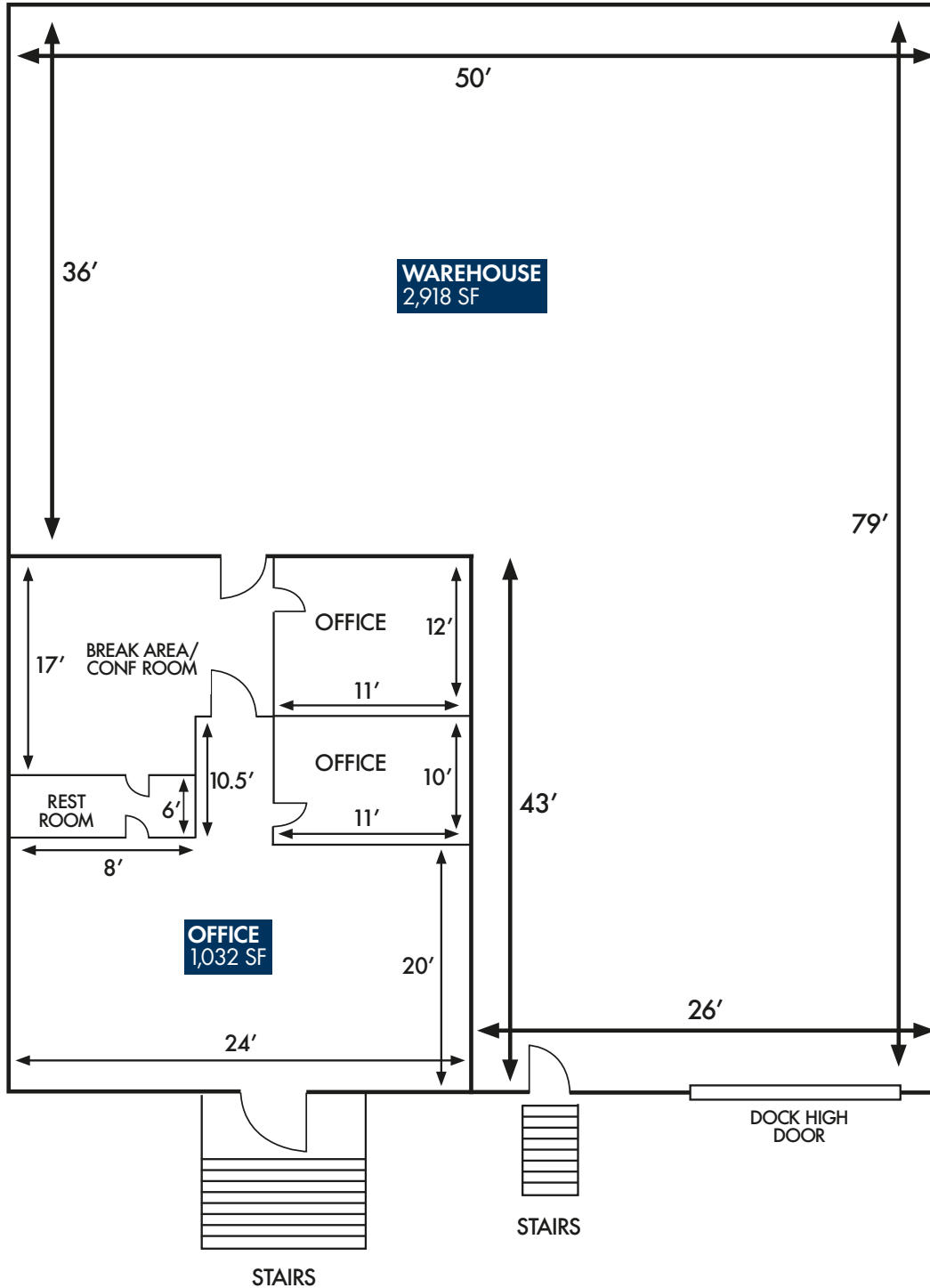
 FOR MORE INFORMATION PLEASE CONTACT **ALEX PAYNE/BRAD ANDRUS**

1517 Centre Place Dr., Ste 250 Denton, TX 76205 Office 940.891.2947 Alex 972.979.7727 Brad 940.368.3588